

220-240V 50 1~

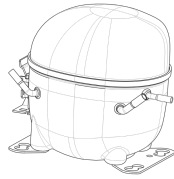

GENERAL DATA

Application: MBP
Refrigerant: R290
Evaporating Temperature Range: -20°C to 10°C
Compressor Cooling: Fan
Fan air flow: 520 m³/h
Type: Hermetic reciprocating
Technology Type: On-Off
Expansion Device: Capillary Tube or Expansion Valve
Packing Quantity: Multi - 28 pcs
Displacement: 12.11 cm³
Horse power: 1.2 hp

Approvals:    

MECHANICAL DATA

Bore: 27.78 mm
Stroke: 20 mm
Oil Charge: 350ml +/-15ml
Free Internal Volume: 2.1 cm³
Maximum Recommended Refrigerant Charge: 150 g
Oil Type Configuration: Polyolester
Oil Type Viscosity: ISO22
Compressor pressurization: Without dry air charge
Weight: 11.9 kg

ELECTRICAL DATA

Motor Type: CSR
Starting Torque: HST
Voltage working range at 50 Hz: 198-254 V
Maximum Motor Temperature: 130 °C
Start Winding Resistance: 27.95 Ω (± 10%) at 25°C
Run Winding Resistance: 5.11 Ω (± 10%) at 25°C
Locked Rotor Amperage (LRA): 18 A

MOUNTING ACCESSORIES

	Description	Code
Terminal Board:	no	-
Anchorage:	no	-
Capacitor Bracket:	no	-
Washer:	no	-
Pin:	no	-
Clip:	no	-
Rotolock valve:	no	-
Grommets:	yes	2221011
Sleeves:	yes	2222018
Overload Protector Bracket:	yes	2075299
Cover:	yes	2075278

ELECTRICAL COMPONENTS

	Component type	Description	Code
Starting Device:	Potential relay	RVA4L3C-566	1253051
Start Capacitor:		53-64 MFD 330V	2252261
Run Capacitor:		7 MFD	2253324
CSR / CSIR Box:	yes		1272383
Motor Protection:	External 3/4"	T0874/G9	2321121

EXTERNAL CHARACTERISTICS

Base Plate: European
Tray Holder: No
Height: 200 mm

	Internal Diameter (mm)	Material	Shape
Suction Connector	8.1	Copper	Slanted 42°
Discharge Connector	6.1	Copper	Straight
Process Connector	6.1	Copper	Slanted 42°

RATED POINT DATA

Cooling Capacity (W)	Power Consumption (W)	Current Consumption (A)	Gas Flow Rate (kg/h)	Efficiency (W/W)
±5%	±5%	±5%	±5%	±7%
943	444	2.36	10.84	2.13

Test condition: EN 12900, Fan, Return Gas 20°C, Subcooling OK, Evaporating: -10°C, Condensing: 45°C, Ambient: 35°C

PERFORMANCE CURVE DATA**220V 50Hz**

Condensing Temperature (°C)	Evaporating Temperature (°C)	Cooling Capacity (W)	Power Consumption (W)	Current Consumption (A)	Gas Flow Rate (kg/h)	Efficiency (W/W)
		±5%	±5%	±5%	±5%	±7%
35°C	10	2 144	495	2.58	23.17	4.33
	5	1 833	473	2.49	19.65	3.88
	0	1 552	451	2.39	16.51	3.44
	-5	1 301	428	2.29	13.75	3.04
	-10	1 079	404	2.19	11.35	2.67
	-15	887	378	2.09	9.29	2.35
	-20	724	350	1.98	7.55	2.07

Condensing Temperature (°C)	Evaporating Temperature (°C)	Cooling Capacity (W)	Power Consumption (W)	Current Consumption (A)	Gas Flow Rate (kg/h)	Efficiency (W/W)
		±5%	±5%	±5%	±5%	±7%
45°C	10	1 904	562	2.85	22.54	3.39
	5	1 623	533	2.73	19.04	3.05
	0	1 370	504	2.61	15.94	2.72
	-5	1 143	474	2.48	13.21	2.41
	-10	943	444	2.36	10.84	2.13
	-15	770	412	2.23	8.81	1.87
	-20	624	378	2.10	7.11	1.65

Condensing Temperature (°C)	Evaporating Temperature (°C)	Cooling Capacity (W)	Power Consumption (W)	Current Consumption (A)	Gas Flow Rate (kg/h)	Efficiency (W/W)
		±5%	±5%	±5%	±5%	±7%
55°C	10	1 648	634	3.17	21.69	2.60
	5	1 401	596	3.01	18.26	2.35
	0	1 179	559	2.85	15.23	2.11
	-5	981	521	2.68	12.57	1.88
	-10	807	483	2.52	10.27	1.67

Test condition: EN 12900, Fan, Return Gas 20°C, Subcooling OK, Ambient: 35°C

ASSEMBLY INSTRUCTION

WIRING DIAGRAM

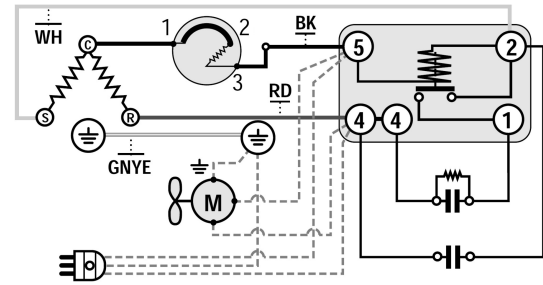
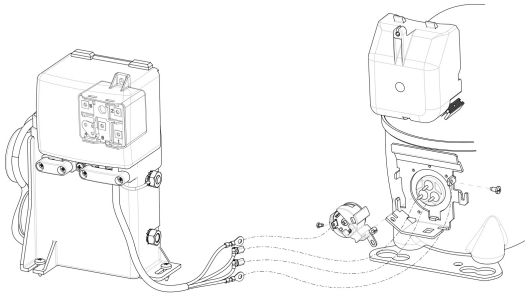

OPERATING ENVELOPE

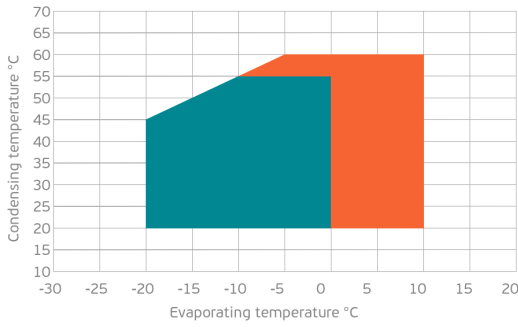

- Operating Condition
- Transient Condition
- Superheating

NOTE: usage of compressors outside of intended working range cannot make use of the warranty, or should be consulted with Technical support.

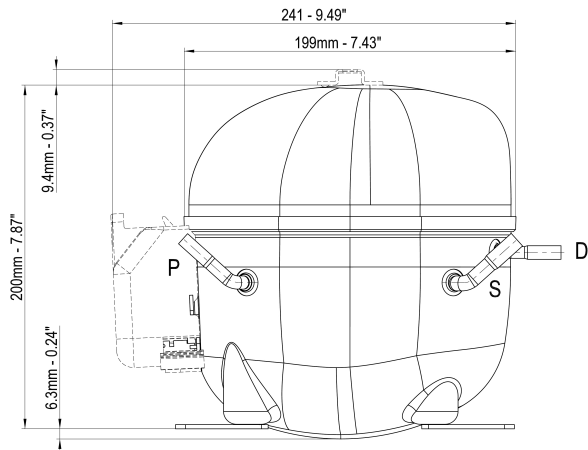

	∅ mm	∅ in	Material
S - Suction	8.10 - 8.20	0.32	Cu
P - Process	6.10 - 6.20	0.24	Cu
D - Discharge	6.10 - 6.20	0.24	Cu

