



Via ALDO ROSSI 4
20149 Milano (MI)
Tel.02518011- Fax 0251801.500



Dati Tecnici Prodotto

Egregi Signori,

Vi inviamo la presentazione tecnica relativa al sistema di climatizzazione che riteniamo particolarmente indicato alla vostra richiesta.

Il Sistema proposto è composto da una Unità Inverter, di concezione molto avanzata ed in grado di fornire le massime prestazioni in termini di comfort ambientale, risparmio energetico ed affidabilità.

▪ L'ampia gamma di unità interne **di tipologia Cassetta 4 Vie, Canalizzabili**, consente di soddisfare qualsiasi esigenza di configurazione dell' impianto..

▪ Questa guida contiene tutte le informazioni riguardanti l'unità interna con alimentazione monofase 220V Modello **CANALIZZABILE CM18F N10**

CM18R N10



▪ Descrizione caratteristiche dell' unità Interna

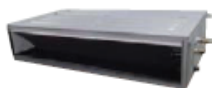

•Capacità / Struttura

Unità interna per installazione a controsoffitto, per sistemi tipo LG ad R32 avente capacità nominale in raffreddamento pari a 6,8 kW e 7,5 kW in riscaldamento. Scocca metallica di contenimento in lamiera d'acciaio zincata con rivestimento in polistirene espanso. Scambiatore di calore costituito da tubi in rame ed alette in alluminio ad alta efficienza.

Dimensioni unità interna in mm pari a 900(L)x270(A)x700(P).

Peso Kg 31,1

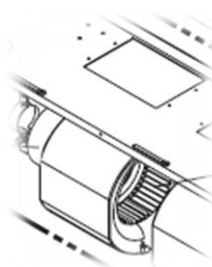

•Motore Ventilatore

Ventilatore tipo Sirocco con motore di ventilazione BLDC ad accoppiamento diretto. Assorbimento Nominale 136,5W.

Portata Aria 16.5 / 14.5 / 13.0 m³/min

Prevalenza statica utile Min 0 Max 150 Pa.

Il motore BLDC permette un controllo della portata d'aria a seconda delle perdite di carico, semplicemente utilizzando il comando a filo, garantendo in questo modo la prevalenza ottimale e riducendo al minimo la rumorosità.

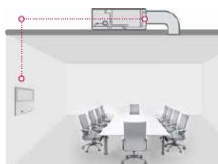

•Controllo temperatura a doppio termistore

Possibilità di rilevare la temperatura interna da due sensori, uno posto sull'unità interna, l'altro posto sul comando a filo.

Il controllo può avvenire per singolo sensore, oppure combinato a doppio termistore per ottenere ed ottimizzare la temperatura dell'aria interna.



• Controllo temperatura a doppio termistore

Possibilità di collegamento WiFi come accessorio con codice **PWFMDD200**



Se viene installato il modulo WIFI l'Unità interna diventa compatibile con gli assistenti vocali Google Home.

Funzioni disponibili :

- Accensione
- Spegnimento
- Regolazione temperatura
- Impostazione modalità operative
- Regolazione ventilazione
- Monitoring

▪ Descrizione delle caratteristiche delle unità Interna

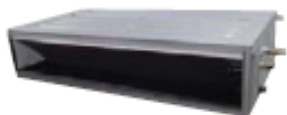

•Dry contact unità interna

Le unità interne possono essere accese /spente grazie alla funzione dry contact integrata.

Vedi impostazioni da comando a filo

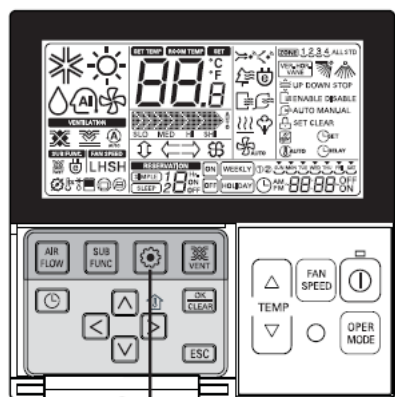

1 Tenendo premuto il pulsante di configurazione delle funzioni per 3 secondi, si entra nella modalità di configurazione tecnica del telecomando.
- Premendolo una sola volta per breve tempo, si accede alla modalità di configurazione utente. Per essere sicuri, tenere premuto per più di 3 secondi.

2 Quando si accede inizialmente alla modalità di impostazione, il codice di funzione è visualizzato nella parte alta dello schermo LCD.

CODICE FUNZIONE COMANDO A FILO	IMPOSTAZIONE	CONTATTO APERTO	CONTATTO CHIUSO	BLOCCO
52	00	UNITA' INTERNA OFF	UNITA' INTERNA ON	NO
	01			
52	02	UNITA' INTERNA OFF	UNITA' INTERNA ON (PARTE IN AUTOMATICO)	SI
52	03	UNITA' INTERNA OFF	UNITA' INTERNA STAND BY (ON DAL COMANDO)	SI

▪ Dati tecnici

Caratteristiche Unità Interna

Model Name			Unit	ZBNW18GM1A1 [CM18F N10]	ZBNW24GM1A1 [CM24F N10]
Power Supply			V , Ø , Hz	220-240, 1, 50 220, 1, 60	220-240, 1, 50 220, 1, 60
Power Input	H / M / L	W		150 / 130 / 110	180 / 150 / 130
Running Current	H / M / L	A		0.85 / 0.76 / 0.67	0.98 / 0.85 / 0.76
	Max.	A		1.60	1.60
Exterior	Color		-	Steel Gray	Steel Gray
Dimensions	W x H x D	mm		900 x 270 x 700	900 x 270 x 700
Net Weight			kg	24.6	24.6
Shipping Weight			kg	31.1	31.1
Heat Exchanger	Rows x Columns x FPI			2 x 13 x 18	2 x 13 x 18
	Face Area		m²	0.21	0.21
Fan Type				Sirocco Fan	Sirocco Fan
Air Flow Rate	H / M / L	m³/min		16.5 / 14.5 / 13.0	18.0 / 16.5 / 14.5
External static pressure	High Mode_ Factory Set		Pa (mmAq)	58.8 (6)	58.8 (6)
Fan Motor	Type			BLDC	BLDC
	Drive			Internal	Internal
	Output		W x No.	136.5 x 1	136.5 x 1
Safety Device				Fuse / Thermal Protector for Fan Motor	
Piping Connections	Liquid Side		mm (inch)	Ø 6.35 (1/4)	Ø 9.52 (3/8)
	Gas Side		mm (inch)	Ø 12.7 (1/2)	Ø 15.88 (5/8)
	Drain Pipe (Natural Drainage)	O.D. / I.D.	mm	Ø 25.4 / 19.4	Ø 25.4 / 19.4
	Drain Pipe (Using Drain Pump)	O.D. / I.D.	mm	Ø 32 / 26	Ø 32 / 26
Sound Pressure Level	Cooling	H / M / L	dB(A)	34 / 32 / 30	35 / 34 / 32
	Heating	H / M / L	dB(A)	34 / 32 / 30	35 / 34 / 32
Sound Power Level	Cooling	Rated	dB(A)	59	60
	Heating	Rated	dB(A)	-	-
Power and Communication Cable (included Earth)			No. x mm²	4C x 0.75	4C x 0.75
Note					
1. Due to our policy of innovation some specifications may be changed without notification.					
2. Wiring cable size must comply with the applicable local and national code. And "Electric characteristics" chapter should be considered for electrical work and design. Especially the power cable and circuit breaker should be selected in accordance with that.					
3. Sound Level Values are measured at Noise Measuring chamber accordance with standard. Therefore, these values depend on the ambient conditions and values are normally higher in actual operation(Sound Pressure : LG Internal standard, Sound Power : EN 12102 (ISO 3741).					
4. Capacities are net capacities and based on the following conditions. Refer to the Outdoor Unit Specifications for calculating the real capacity.					
<ul style="list-style-type: none"> • Cooling : Indoor Ambient Temp. 27°CDB / 19°CWB, Outdoor Ambient Temp. 35°CDB / 24°CWB • Heating : Indoor Ambient Temp. 20°CDB / 15°CWB, Outdoor Ambient Temp. 7°CDB / 6°CWB • Interconnected Pipe is standard length and difference of Elevation (Outdoor ~ Indoor Unit) is 0m. 					

FUNZIONI DISPONIBILI

Category	Functions	ZBNW18GM1A0 [CM18R N10] ZBNW24GM1A0 [CM24R N10] ZBNW30GM1A0 [UM30R N10] ZBNW36GM2A0 [UM36R N20] ZBNW42GM2A0 [UM42R N20] ZBNW48GM3A0 [UM48R N30] ZBNW60GM3A0 [UM60R N30]
Air flow	Air supply outlet	1
	Airflow direction control (left & right)	X
	Airflow direction control (up & down)	X
	Auto swing (left & right)	X
	Auto swing (up & down)	X
	Airflow steps (fan/cool/heat)	3 / 3 / 3
	Chaos wind(auto wind)	X
	Jet cool/heat	X / X
Air purifying	Swirl wind	X
	Triple filter (Deodorizing)	X
	Plasma air purifier	X
	Allergy Safe filter	X
Installation	Long-life prefilter (washable / anti-fungus)	O
	Drain pump	ABDPG
	E.S.P. control*	O
	Electric heater	X
Reliability	High ceiling operation*	X
	Hot start	O
Convenience	Self diagnosis	O
	Auto changeover	O
	Auto cleaning	X
	Auto operation(artificial intelligence)	X
	Auto Restart	O
	Child lock*	O
	Forced operation	X
	Group control*	O
	Sleep mode	O
	Timer(on/off)	O
	Timer(weekly)*	O
	Two thermistor control*	O
Special Functions	Auto Elevation Grille	X
	Wi-Fi	O (Accessory)
Comes with product	Humidity Control	X
	Wireless Remote Controller	X
	Wired Remote Controller	O**
Network Solution(LGAP)		O
Note 1. O : Applied, X : Not applied Accessory model name : Installed at field, ordered and purchased separately by the corresponding model name, supplied with separate package. 2. Some functions can be limited by remote controller. 3. In case of ducted type indoor units using the wireless remote controller, it needs to connect the wired remote controller for received the signal of that. 4. In case of cassette type indoor units, Plasma kit and Auto Elevation Grille functions are not applicable at the same time. 5. * : These functions need to connect the wired remote controller. 6. ** : It is included by default when the product is manufactured.		

ACCESSORI COMPATIBILI

Category	Product	Remark	ZBNW18GM1A0 [CM18R N10] ZBNW24GM1A0 [CM24R N10] ZBNW30GM1A0 [UM30R N10] ZBNW36GM2A0 [UM36R N20] ZBNW42GM2A0 [UM42R N20] ZBNW48GM3A0 [UM48R N30] ZBNW60GM3A0 [UM60R N30]	
Wireless Remote Controller	PQWRHQ0FDB	Heat Pump	O***	
Wired Remote Controller	Simple	PQRCVCL0Q(W)	Simple	O
		PQRCHCA0Q(W)	for Hotel	O
	Standard	PREMTB001	Standard (White)	O
		PREMTBB01	Standard (Black)	O
PREMTB100**		New Standard (White)	O	
Premium	PREMTA000(A/B)	Premium	O	
Dry contact	Simple Contact	PDRYCB000	Simple Dry Contact	O
	Communication type	PDRYCB400	2 Points Dry Contact (For Setback)	O
		PDRYCB300	-	O
		PDRYCB500	Dry Contact For Modbus	O
Gateway	IDU PI485	PHNFP14A0	Connected with the Indoor Units	X
		PSNFP14A0	Connected with the Indoor Units	X
ETC	Remote temperature sensor	PQRSTA0	-	O
	Zone controller	ABZCA	-	O
	Electronic thermostat	AQETC	-	X
	CTI (Communication transfer interface)	PKFC0	-	X
	CO ₂ Sensor	PES-C0RV0	For ERV, ERV DX Indoor units	X
	Group control wire	PZCWRCG3	0.25m	O
	2-Remo Control Wire	PZCWRC2	0.25m	O
	Extension Wire	PZCWRC1	10m	O
Wi-Fi Controller*	PWFMD200	-	O	

Note

1. O: Possible, X: Impossible, - : Not applicable
 2. * : Some advanced functions controlled by individual controller cannot be operated.
 3. ** : It could not be operated some functions.
 4. If you need more detail, please refer to the *BECON* PDB or the manual of product.
(<http://partner.lge.com/global> : Home> Download> Manuals)
- *** : In case of ducted type indoor units using the wireless remote controller, it needs to connect the wired remote controller for received the signal of that.

▪ SCHEMA DIMENSIONALE UNITA' INTERNA

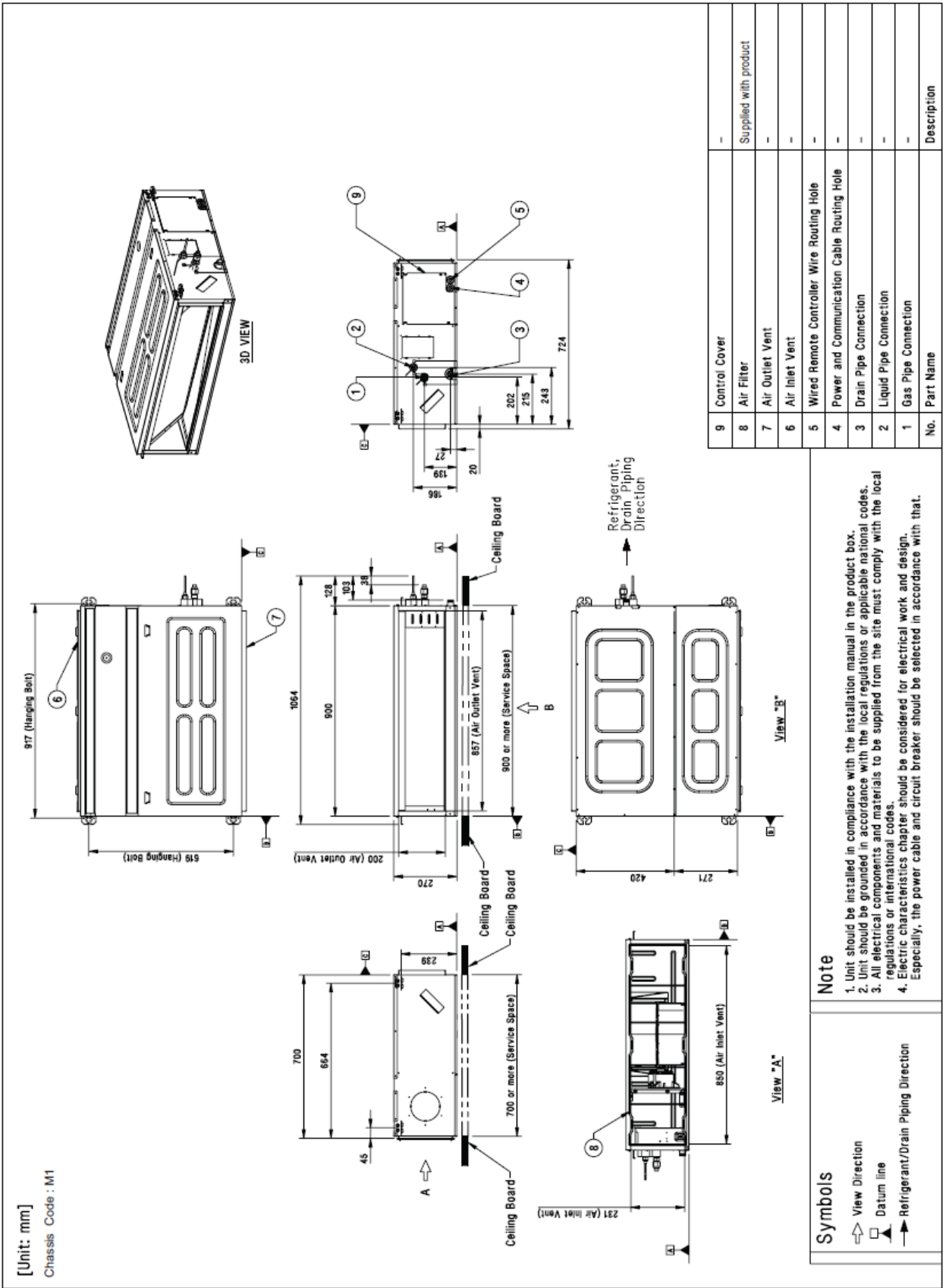

Note

1. Unit should be installed in compliance with the installation manual in the product box.
2. Unit should be grounded in accordance with the local regulations or applicable national codes.
3. All electrical components and materials to be supplied from the site must comply with the local regulations or international codes.
4. Electric Characteristics chapter should be considered for electrical work and design. Especially, the power cable and circuit breaker should be selected in accordance with that.

Symbols

- ↑ View Direction
- Datum line
- Refrigerant/Drain Piping Direction

No.	Part Name	Description
9	Control Cover	-
8	Air Filter	Supplied with product
7	Air Outlet Vent	-
6	Air Inlet Vent	-
5	Wired Remote Controller Wire Routing Hole	-
4	Power and Communication Cable Routing Hole	-
3	Drain Pipe Connection	-
2	Liquid Pipe Connection	-
1	Gas Pipe Connection	-

COLLEGAMENTI ELETTRICI E SPECIFICHE DI CABLAGGIO

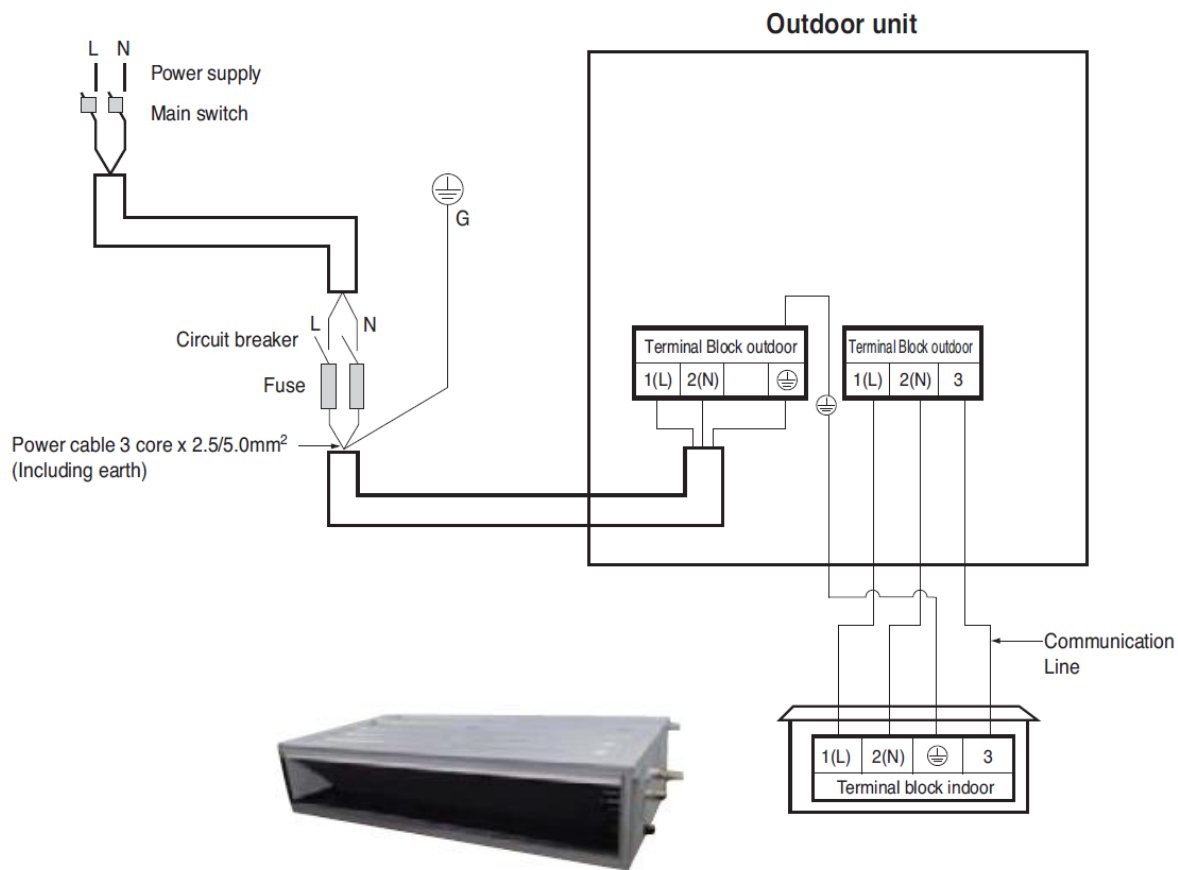

EU DECLARATION OF CONFORMITY¹



Number²

E_DMZ_CM18F_DOC_20191024000001

Name and address of the Manufacturer³

LG Electronics Inc.
 LG Twin Towers, 128 Yeouui-daero, Yeongdeungpo-gu, Seoul, 07336, Korea

This declaration of conformity is issued under the sole responsibility of the manufacturer.⁴

Object of the declaration⁵

Product information⁶

Product Name HEATPUMP	Model Name CM18F N10, ZBNW18GM1A1
---------------------------------	---

Additional information⁷

Serial number is marked in the bar code label on the product

The object of the declaration described above is in conformity with the relevant Union harmonisation legislation:⁸

- References to the relevant harmonised standards used or references to the technical specifications in relation to which conformity is declared⁹

EMC Directive 2014/30/EU

EN 55014-1:2017	EN 55014-2:2015
EN 61000-3-2:2019	EN 61000-3-3:2013

Low Voltage Directive 2014/35/EU

EN 60335-1:2012+A11:2014+A13:2017	EN 60335-2-40:2003+A11:2004+A12:2005+A1:2006+A2:2009+A13:2012
EN 62233:2008	

Ecodesign Directive 2009/125/EC

Regulation 327/2011/EU

RoHS Directive 2011/65/EU (as amended by EU 2015/863)

EN 50581:2012

The notified body¹⁰
 and issued the certificate

performed
 N/A

Additional information⁷

N/A

Signed for and on behalf of:¹¹ LG Electronics Inc.

Authorized Representative:
 LG Electronics European Shared Service Center B.V.
 Krijgsman 1, 1186 DM Amstelveen, The Netherlands

Name and Surname / Function:
 Yun Hee Yang / Director

Date of issue:
 24th. October. 2019



Copyright © 2020 LG Electronics Inc.

Tutti I diritti riservati.

Nessuna parte di questa opera può essere riprodotta e distribuita in qualsiasi forma e con qualsiasi mezzo senza il consenso scritto dell'autore.

Info Clienti: 199 600 099

Servizio a pagamento: tariffa massima 11,88 Centesimi di Euro al minuto (iva esclusa). I costi da telefonia mobile variano in funzione dell'operatore utilizzato.

LG Electronics Italia S.p.A.

Via Aldo Rossi, 4
20149 Milano
Tel.02518011-Fax 0251801500

Via Gian Lorenzo Bernini, 5
00054 Fiumicino (RM)
Tel.0659290007-Fax 065914740

www.lgbusiness.it

www.lg.com/it

Per la politica di continuo miglioramento dei prodotti, LG si riserva il diritto di modificare dati e immagini senza obbligo di preavviso.
Copyright © 2018 LG Electronics. All rights reserved.