

220-240V 50 1~**GENERAL DATA**

Application: LBP
Refrigerant: R290
Evaporating Temperature Range: -40°C to -10°C
Compressor Cooling: Fan
Fan air flow: 520 m³/h
Type: Hermetic reciprocating
Technology Type: On-Off
Expansion Device: Capillary Tube or Expansion Valve
Packing Quantity: Single - 1 pc
Displacement: 22.4 cm³
Horse power: 1 hp

Approvals:    

MECHANICAL DATA

Bore: 36.99 mm
Stroke: 20.83 mm
Oil Charge: 450ml +/-15ml
Free Internal Volume: 3.3 cm³
Maximum Recommended Refrigerant Charge: 150 g
Oil Type Configuration: Polyolester
Oil Type Viscosity: ISO22
Compressor pressurization: Without dry air charge
Weight: 17.7 kg

ELECTRICAL DATA

Motor Type: CSIR
Starting Torque: HST
Voltage working range at 50 Hz: 198-254 V
Maximum Motor Temperature: 130 °C
Start Winding Resistance: 8.4 Ω (± 10%) at 25°C
Run Winding Resistance: 1.9 Ω (± 10%) at 25°C

MOUNTING ACCESSORIES

	Description	Code
Anchorage:	no	-
Grommets:	yes	2221004
Sleeves:	yes	2222016
Washer:	no	-
Pin:	no	-
Clip:	no	-
Rotolock valve:	no	-
Cover:	yes	2075282
Terminal Board:	yes	1027060
Overload Protector Bracket:	yes	2075299
Capacitor Bracket:	yes	2255007

ELECTRICAL COMPONENTS

	Component type	Description	Code
Start Capacitor:		43-53 MFD 330V	2252375
Starting Device:	Current relay	MTRPH-59-65	2334134
Motor Protection:	External 3/4"	T0624/G6	2319096

EXTERNAL CHARACTERISTICS

Base Plate: Universal
Tray Holder: No
Height: 234 mm

	Internal Diameter (mm)	Material	Shape
Suction Connector	9.6	Copper	Vertical
Discharge Connector	6.42	Copper	Vertical
Process Connector	6.42	Copper	Vertical

RATED POINT DATA

Cooling Capacity (W)	Power Consumption (W)	Current Consumption (A)	Gas Flow Rate (kg/h)	Efficiency (W/W)
±5%	±5%	±5%	±5%	±7%
935	694	4.59	9.50	1.35

Test condition: ASHRAE, Fan, Return Gas 32.2°C, Evaporating: -23.3°C, Condensing: 54°C, Ambient: 32.2°C, Liquid: 32.2°C

PERFORMANCE CURVE DATA**220V 50Hz**

Condensing Temperature (°C)	Evaporating Temperature (°C)	Cooling Capacity (W)	Power Consumption (W)	Current Consumption (A)	Gas Flow Rate (kg/h)	Efficiency (W/W)
		±5%	±5%	±5%	±5%	±7%
35°C	-10	1 882	789	4.96	19.33	2.39
	-15	1 550	728	4.73	15.84	2.13
	-20	1 256	667	4.51	12.79	1.88
	-25	1 002	605	4.30	10.17	1.66
	-30	787	543	4.11	7.97	1.45
	-35	611	480	3.93	6.17	1.27
	-40	475	417	3.77	4.79	1.14

Condensing Temperature (°C)	Evaporating Temperature (°C)	Cooling Capacity (W)	Power Consumption (W)	Current Consumption (A)	Gas Flow Rate (kg/h)	Efficiency (W/W)
		±5%	±5%	±5%	±5%	±7%
45°C	-10	1 747	865	5.25	17.93	2.02
	-15	1 441	789	4.95	14.73	1.83
	-20	1 170	715	4.67	11.91	1.64
	-25	932	641	4.42	9.46	1.45
	-30	728	568	4.19	7.37	1.28
	-35	559	496	3.98	5.64	1.13

Condensing Temperature (°C)	Evaporating Temperature (°C)	Cooling Capacity (W)	Power Consumption (W)	Current Consumption (A)	Gas Flow Rate (kg/h)	Efficiency (W/W)
		±5%	±5%	±5%	±5%	±7%
55°C	-10	1 610	935	5.52	16.52	1.72
	-15	1 329	844	5.15	13.58	1.57
	-20	1 077	754	4.81	10.96	1.43
	-25	854	667	4.50	8.67	1.28
	-30	660	581	4.23	6.68	1.14

Test condition: ASHRAE, Fan, Return Gas 32.2°C, Ambient: 32.2°C, Liquid: 32.2°C

ASSEMBLY INSTRUCTION

WIRING DIAGRAM

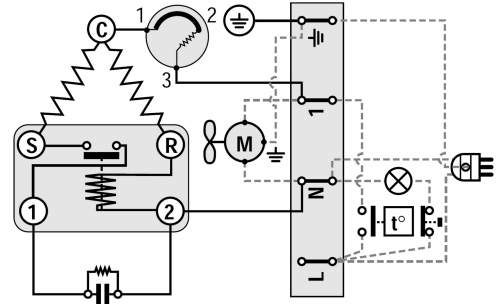
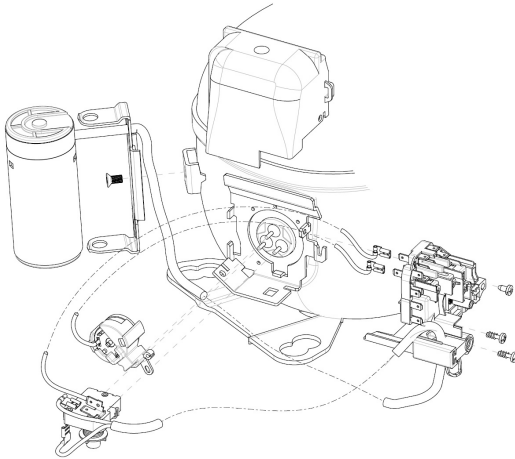

OPERATING ENVELOPE

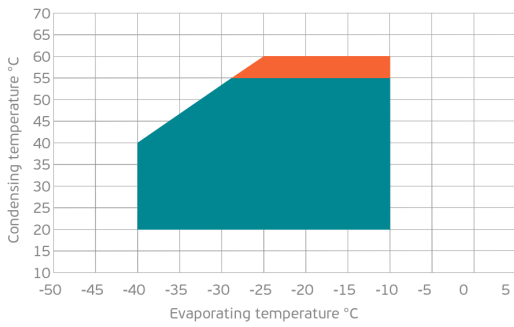

- Operating Condition
- Transient Condition
- Superheating

NOTE: usage of compressors outside of intended working range cannot make use of the warranty, or should be consulted with Technical support.

