

CH-706A

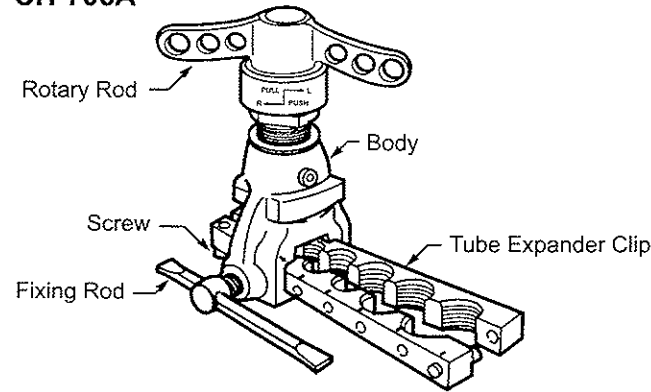

CH-806A

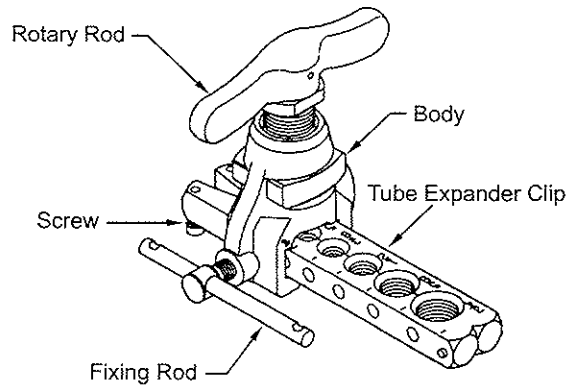

OPERATION INSTRUCTIONS Eccentric Type Flaring Tool

ANGLE : 45°

USES : Suitable for soft copper tube, aluminium tube and other soft tubes,ect.

SIZE :

- 6, 8, 10, 12, 14, 16, 19 mm O.D.
- 1/4, 5/16, 3/8, 1/2, 5/8, 3/4 O.D.
- 3/16, 1/4, 5/16, 3/8, 1/2, 5/8, 3/4 O.D.

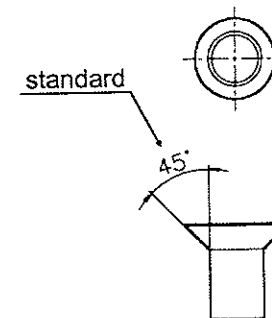

CH-806B

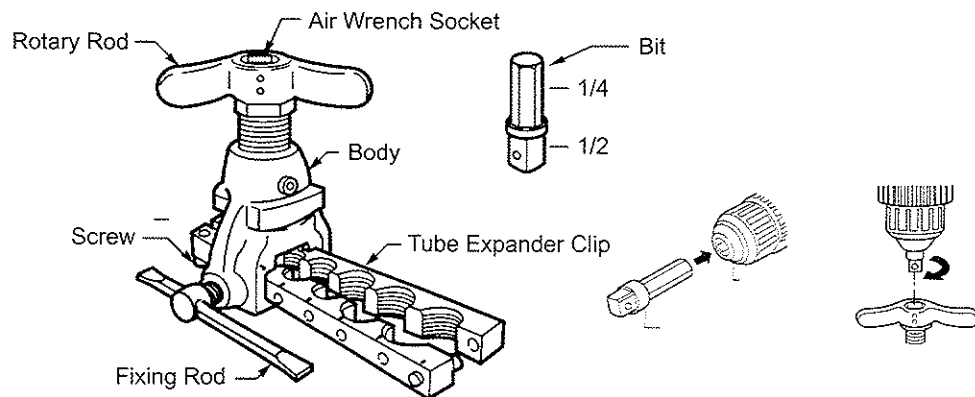

MAINTENANCE INSTRUCTIONS:

1. Keep 45° place of the circular cone clean away from copper dust after using (see Fig 7)
2. Lubricate engine oil frequently on the fixing rod and rotary rod.
3. Be sure to put in tallow frequently on bearing inside the body, and the connection of rotary rod as well as screw.

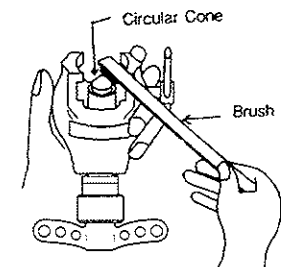
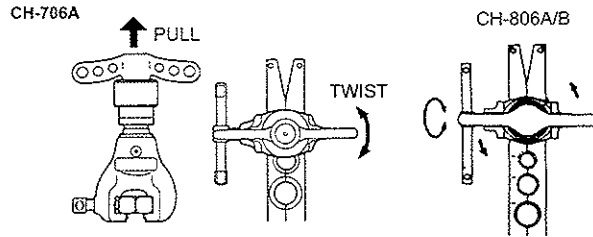

Fig. 7

OPERATION INSTRUCTIONS

1. Loosen the fixing rod before using. Then, pull and twist the rotary rod up to the very top end.



2. Open the tube expander clip and place a tube according to required dimension.

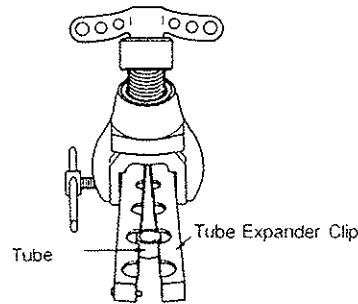

3. What the tube put in should be higher than the plane of the tube expander clip about 1m/m and clean out the tube away from impurities before operation.

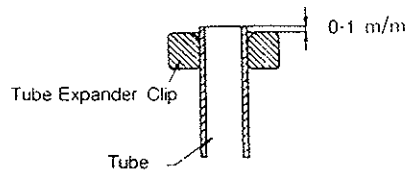

4. Aim the red arrow in front of cone clip to the required dimension line, then, tight lock the fixing rod.

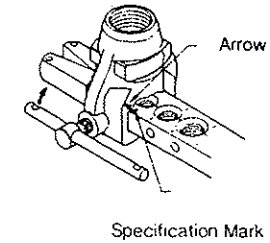

5. Push the rotary rod and turn down. The tube will loose automatically after the tube expanded. Then, again make racing for 2-3 circles to keep the horn aperture smooth and bright.

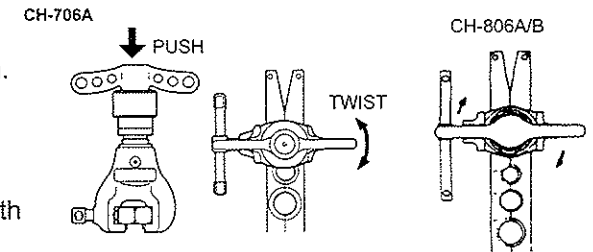

6. After operation completed, pull and twist the rotary rod up to the very top end. However, be sure that backward isn't allowed until the center besides of the rotary rod is put inside in a hole. Then, loose the fixing rod to open the tube expander clip and take the tube out.

